

BATTERY POWERED THERMOMETER

DM540 SERIES

- NEVER NEEDS CALIBRATING
- MAXIMUM LOGGING
- IP65 ENCLOSURE
- 100 mm SS DIAL GAUGE HOUSING
- Pt100 SENSOR
- 5 YEAR WARRANTY



INTRODUCTION

The DM540 is a battery powered digital thermometer that indicates temperature with a continuous viewing display, updated at a user selectable 1, 6 or 12 second interval and stores the MAXIMUM and MINIMUM readings for later recall.

The DM540 series combines high accuracy and long battery life with a large display and uses a special measurement circuit that measures the resistance of the Pt100 sensor as a ratio to a single high accuracy and highly stable resistor. The net result being, for the majority of applications, a 'THERMOMETER THAT NEVER NEEDS CALIBRATION' that is housed in a standard 100mm circular case and conforms to European EMC requirements for both Emissions and Immunity.

SPECIFICATIONS @ 20 °C

Display	LCD, 4 digit 20 mm high
Update	6 s. standard 1 s or 12 s user selectable
Battery	4 x AA Alkaline Manganese (IEC LR6)
Battery Life	32 weeks (@ 1 s update) 1.5 years (@ 6 s update) 2.25 years (@ 12 s update)
Low Battery	The low battery indicator will be displayed when there is approx. a ½ million reading capability remaining (typically 1 month at a 6 seconds reading interval). Battery life is reduced if operated at the higher ambient temperatures.
Range	(-50 to 399.9) °C, 0.1 °C resolution or (-58 to 600) °F, 1 °F resolution
Ambient Accuracy	(0 to 50) °C continuously DM540, ± 0.1 °C ± 0.15 % rdg (± 1 °F) plus sensor error
Drift	Temperature < 0.001 °C / °C Time ± 0.01 °C/year
Sensor	Pt100 2 or 3 wire to BS EN 60751, BS 1904, DIN 43760

APPROVALS	
EMC	BS EN 61326

FUNCTIONAL DETAILS	
Max./Min.	The instrument provides MAXIMUM and MINIMUM indication and resetting by pushing the appropriate "tactile" button on the front panel.

MECHANICAL	
Weight	0.23 Kg

BATTERY POWERED THERMOMETER

MECHANICAL DETAILS

(All dimensions in mm)

CASE STYLE A. SIDE ENTRY

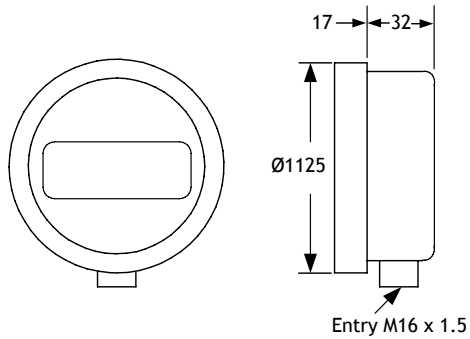

CASE STYLE C. REAR ENTRY

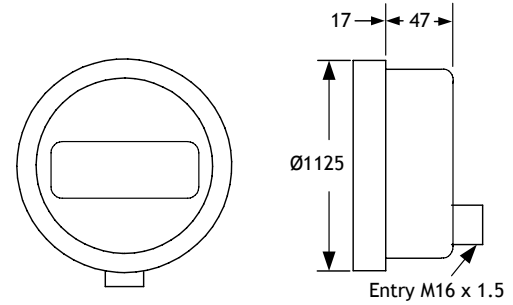

CASE STYLE B. WALL MOUNTING

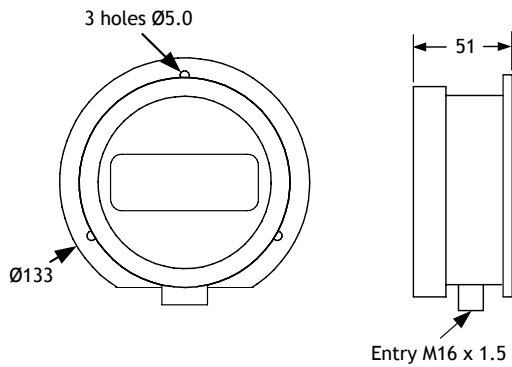

CASE STYLE D. PANEL MOUNTING

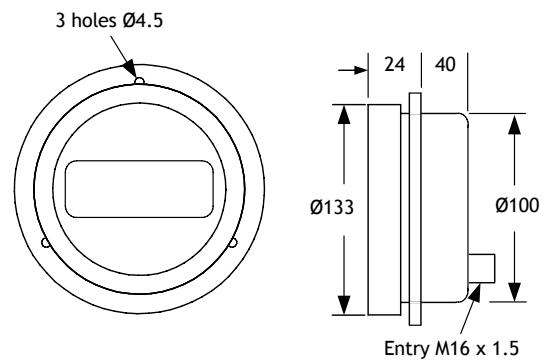

ORDER CODE

MODEL	CASE STYLE	SENSOR ASSEMBLY	CLASS
DM540	Standard version		
CASE STYLE			
	Standard side entry	A	
	Wall mount side entry	B	
	Standard rear entry	C	
	Panel mount rear entry	D	
ASSEMBLY			
	Indicator only	0	
	For use with gland	2	
	Flexible sheathing	8	
	Fixed probe	9	
CLASS			
	Sensor to BS1904 class A		A
	Sensor to BS1904 class B std.		B
	Sensor 1/10 DIN 43760		D

ACCESSORIES & OPTIONS

ACC540-01	Adaptor M16 to M24
ACC540-02	Adaptor M16 to M24 with swivel nut
BATT/AA/PAK	Spare set of batteries